

OREGON PUBLIC LAND CORNER REPORT / RESTORATION REPORT  
Tillamook County Surveyor's Office

SECTION: North 1/16 <sup>th</sup> corner of Section 18	TOWNSHIP 2 South	RANGE 9 West
-----------------------------------------------------------	------------------	--------------

COUNTY: Tillamook	DATE: 05-11-15
-------------------	----------------

<b>Corner Designation:</b> The North 1/16 <sup>th</sup> corner of Section 13, Township 2 South, Range 10 West & Section 18, Township 2 South, Range 9 West; W.M., Tillamook County, Oregon.	(Please check one)	
	<input checked="" type="checkbox"/>	Condition Report Only
	<input type="checkbox"/>	Restoration
	<input type="checkbox"/>	Rewitness
	<input type="checkbox"/>	Unrecorded
	<input type="checkbox"/>	Brass Cap set at surface
<input type="checkbox"/>	Referenced Out	

**Previous Rewitnesses, Restorations and Surveys, etc.:** See Map B-700, A-8393, Tillamook County Survey Records.

**Found Monument(s) and Accessories (Condition & Source):** Found 3" diameter Crown Zellerbach Brass Cap in good condition and flush with the ground and stamped as shown hereon.

**Monument Set (Procedures and Description):** N/A

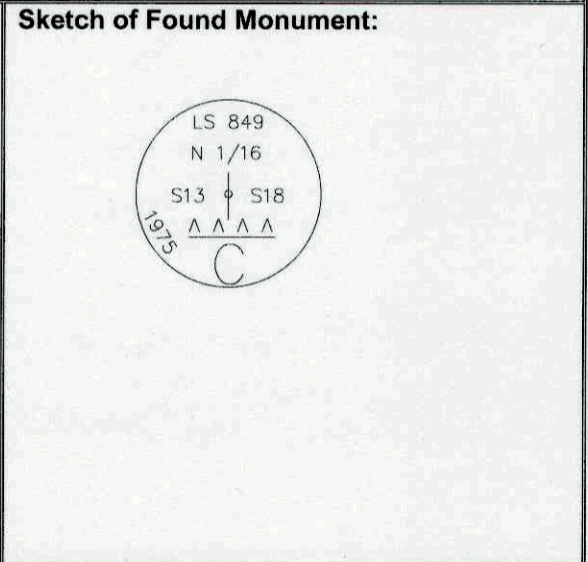

**New accessories set:** None. The purpose of this condition report is to establish GPS coordinates on the corner monument. A direct GPS observation could not be obtained on this corner. GPS control points were established to field-tie the corner monument using a TOPCON total station.

**New Bearing Trees set:** No new bearing trees were marked.

**Location & Comments:** This corner is located approximately 10 feet South of an existing logging road on the top of a cut bank.

**Firm / Agency**  
**Address:** TILLAMOOK COUNTY SURVEYOR'S OFFICE  
 201 Laurel Avenue  
 Tillamook, Oregon 97141

**Party Chief:** Joe Jensen, PLS 60067, Survey Supervisor and Deputy County Surveyor.

**Notes:** NAD83: N=650297.567, E=7343147.336, U.S. Survey Foot; WGS84; Latitude=45°24'05.79956", Longitude=123°50'42.49695"; Convergence= - 2°22'23.20326"; Grid Scale Factor=0.99990285

**Witnesses:** Danny R. McNutt, PLS 49230, Tillamook County Surveyor; Michael R. Rice, PLS 86926, Survey Technician.

**SURVEYOR'S SEAL**

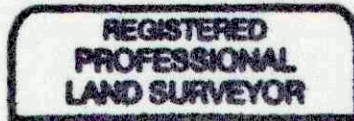

*Joseph V. Jensen*



RENEWAL DATE: 08-30-15

